

MODEL SF-275

**SteamFast**

**Steam Cleaner**

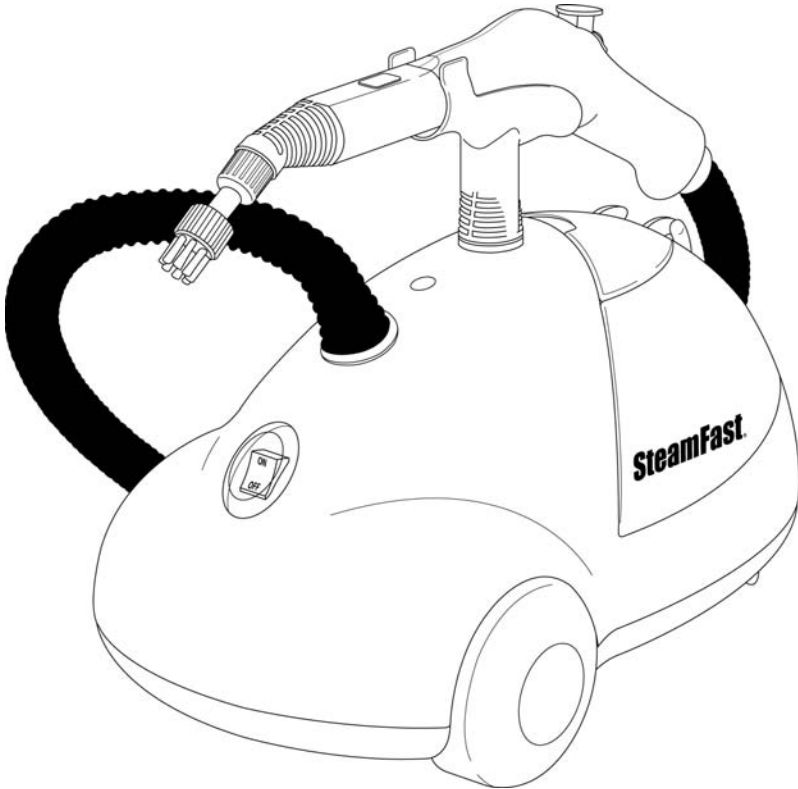

**by Top Innovations, Inc.**

**Please read all instructions before use.  
Mail in your warranty registration card.**

**Dear Valued Customer,**

Congratulations on purchasing your new **SF-275 Steam Cleaner**. This powerful product places the natural cleaning power of steam in a convenient appliance that is perfect for use anywhere around the home - inside or out.

Plug your **Steam Cleaner** in, and in minutes you are ready to eliminate dirt, grease, grime, stains and more from most anywhere in or around your home. In addition to removing dirt and grime, you will receive the many benefits that steam provides. Hot steam kills germs, bacteria, mold and mildew. It also refreshes upholstery and eliminates smoke and other unpleasant odors, making your carpet and furniture like new again. Use it in your living room, kitchen, bedrooms, bathrooms, and anywhere else that you need to clean. Windows, vents, countertops, floors, appliances, cars, barbecue grills, patio furniture and much more will all benefit from the natural cleaning power of steam. And when you're finished steaming, the **Steam Cleaner** is quick and convenient to clean and store.

Top Innovations, Inc. would like to invite you to visit our Customer Support web site at:

**[www.SteamFast.com](http://www.SteamFast.com)**

On this website you will find additional information about many other exciting products that are available, helpful tips on ways in which you can utilize your **Steam Cleaner**, and other useful information to assist you in maximizing the power of steam!

Enjoy your new **SF-275 Steam Cleaner**!



Benny Lee  
Chairman and CEO  
Top Innovations, Inc.

# IMPORTANT SAFEGUARDS

**SteamFast**



**WARNING:** To reduce the risk of fire, electrical shock, or injury, the following basic safety precautions should always be followed when using an electrical appliance.

## READ ALL INSTRUCTIONS BEFORE USING YOUR STEAM CLEANER

1. DO NOT overfill unit with water. DO NOT fill Water Reservoir with more than 48 oz. (1,420 ml.) of water. Overfilling may result in burns from spilling water, or possible electrical shock.
2. DO NOT leave your SF-275 unattended when plugged in or not in use. Use only for its intended purpose as indicated in this manual.
3.  **This unit is not a toy. Close supervision is required when using unit near children, pets, and plants. Steam produced by unit is hot and pressurized. Care must be taken to avoid burns or other injuries. Never point nozzle at people or pets.**
4. To reduce the risk of contact with hot water emitting from steam vents, hold appliance away from body and check for signs of condensation or leakage.
5. DO NOT use this unit if electrical cord or outlet is damaged. DO NOT use unit if it is not working properly or has been dropped, damaged or left outdoors. If such damage occurs, DO NOT disassemble or attempt repairs, take unit to a qualified service person for examination and repair. Incorrect reassembly or repair could cause a risk of fire, electrical shock, or injury to persons when steamer is used.
6. To reduce risk of electrical shock, DO NOT immerse in water or other liquids. DO NOT use electrical cord as a handle. DO NOT allow cord to be crimped by closing it in doors. DO NOT pull or stretch cord around sharp corners or edges.
7. Do not allow cord to touch hot surfaces. Let appliance cool completely before putting away. Loop cord loosely around appliance when storing.
8. DO NOT use this unit with extension cords or electrical outlets that have inadequate current capacity.

## SAVE THESE INSTRUCTIONS!

FOR HOUSEHOLD USE ONLY



**WARNING:** To reduce the risk of electrical shock, this appliance has a three-pronged plug. This plug will fit in a polarized wall outlet only one way. If the plug does not fit fully in the outlet, contact a licensed electrician to install a proper outlet. **DO NOT** attempt to modify the plug or defeat this safety feature.

9. In order to unplug SF-275, grasp plug and pull smoothly and firmly from outlet. **DO NOT** attempt to unplug unit by pulling or tugging on cord.
10. Burns could occur from touching hot metal parts, hot water or steam. Use care when you turn a steam appliance upside down - there may be hot water in Water Reservoir.
11. SF-275 is only meant to be used with recommended SF-275 accessories. Other types of attachments are not to be used with Multi-Purpose Steamer. Doing so may cause injuries or damage to unit.
12. Nozzle and attachments become hot during use. To avoid injuries, **DO NOT** touch nozzle while using this appliance. **DO NOT** attempt to change attachments while unit is emitting steam.
13. When filling your SF-275, only water should be used in unit. Other cleaning agents will damage unit and can cause injuries.
14. Always disconnect appliance from electrical outlet when filling with water or emptying, and when not in use.
15. To avoid burns from escaping steam when removing Water Reservoir cap to refill unit:
  - Always allow unit to cool for 5-10 minutes.
  - Press and hold Steam Button to release all remaining steam.
16. **DO NOT** operate unit if steam opening is blocked. Should this occur, immediately cease usage and unplug from electrical outlet.
17. Store your SF-275 Steam Cleaner in a cool, dry place.

**SAVE THESE INSTRUCTIONS!**

**FOR HOUSEHOLD USE ONLY**

# STEAM CLEANER PRODUCT INFORMATION

**SteamFast**

The following features and accessories are included with your Steam Cleaner. Carefully inspect packaging material as some parts are shipped inside Styrofoam packaging. To obtain possible missing parts, refer to the **Customer Support** section on page 13 of this manual.

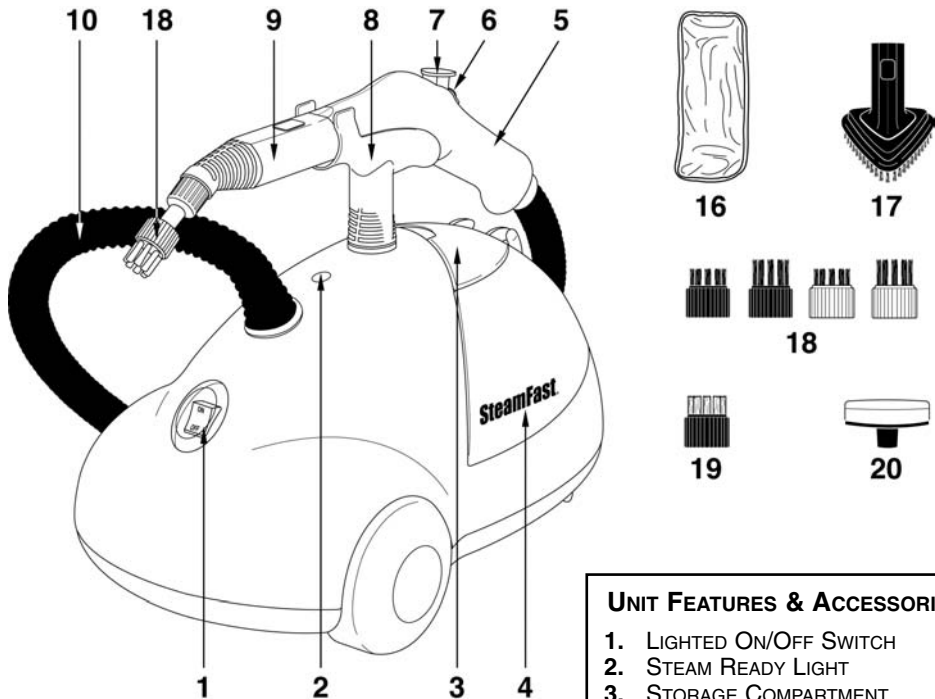

16



17



18



19



20

## UNIT FEATURES & ACCESSORIES

1. LIGHTED ON/OFF SWITCH
2. STEAM READY LIGHT
3. STORAGE COMPARTMENT
4. WATER RESERVOIR
5. HANDLE
6. STEAM LOCK SWITCH
7. STEAM BUTTON
8. CARRY HANDLE
9. STEAM JET NOZZLE
10. STEAM HOSE
11. FLOOR BRUSH
12. SQUEEGEE
13. EXTENSION WANDS
14. WATER FUNNEL
15. MEASURING CUP
16. CLOTH TOWEL
17. TRIANGLE BRUSH
18. ASSORTED UTILITY BRUSHES
19. BRASS UTILITY BRUSH
20. SCRUB PAD

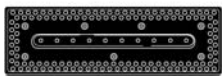

11



13



14



12



15

- The *Lighted On/Off Switch* (1) provides a clear visual indication of whether the unit is powered on.
- The *Steam Ready Light* (2) indicates when the unit is ready to begin steaming.
- The *Storage Compartment* (3) is used for storing small accessories, and houses the *Water Reservoir* cap.
- The *Water Reservoir* (4) is the tank in which water is stored for use by the unit. It is accessed by removing the *Water Reservoir* cap found inside the *Storage Compartment*. There must be a sufficient amount of water (16-48 oz. / 473-1,420 ml.) in the *Water Reservoir* in order for the unit to properly function.
- The *Handle* (5) is designed to stay relatively cool while providing the optimum amount of safety and user comfort.
- The *Steam Lock Switch* (6) is pushed forward to lock the *Steam Button* down and provide continuous steam.
- The *Steam Button* (7) is depressed in order to release a spray of hot, penetrating steam from the unit.
- The *Carry Handle* (8) provides a convenient place to set the main steam nozzle, and is useful for carrying the unit up stairs and over obstacles.
- The *Steam Jet Nozzle* (9) focuses the spray of steam from the unit, and serves as the base to which all other accessories connect.
- The *Steam Hose* (10) safely channels the flow of steam from the units boiler to the main steam nozzle.
- The *Floor Brush* (11) is useful for cleaning floors and other large surfaces. The *Cloth Towel* (16) attaches to the *Floor Brush* for cleaning tile and other hard surface floors.
- The *Squeegee* (12) can be used to clean mirrors, windows and other smooth glass surfaces.
- The *Extension Wands* (13) connect to the main steam nozzle, allowing easy cleaning in hard-to-reach places.
- The *Water Funnel* (14) and the *Measuring Cup* (15) are provided to assist you in easily and consistently filling the *Water Reservoir* with the optimum amount of water (16-48 oz. / 473-1,420 ml.).
- The *Triangle Brush* (17) is designed for cleaning corners and other difficult angles.
- The *Assorted Utility Brushes* (18) attach to the *Steam Jet Nozzle*, providing extra power for removing exceptionally tough dirt and stains.
- The *Brass Utility Brush* (19) attaches to the *Steam Jet Nozzle* and is designed for removing tough stuck-on grease and grime from ovens and grills.
- The *Scrub Pad* (20) attaches to the *Steam Jet Nozzle* and is used to clean porcelain and countertops.

## ATTACHING CARRY HANDLE

1. Insert Carry Handle into Carry Handle hole on top of unit. Please refer to illustration for assistance with proper alignment (FIGURE 1).
2. Use enclosed magnetic screw driver and screw to securely fasten Carry Handle to unit.



FIGURE 1

## ATTACHING MAIN ACCESSORIES

**WARNING: Do not try to connect accessories while unit is emitting steam.**

**This section applies to the Steam Jet Nozzle, Squeegee, Floor Brush, Extension Wands and Triangle Brush.**

1. Depress red lock/release button on main steam nozzle (FIGURE 2-A).
2. While still depressing lock/release button, slide Steam Jet Nozzle or other accessory over this button, so that rectangular hole in attachment aligns with lock/release button (FIGURE 2-B).
3. Once lock/release button and rectangular hole are properly aligned, button should *click* through hole and into place.
4. To remove Steam Jet Nozzle or other nozzle, press in red lock/release button and pull attachment off of main steam nozzle.

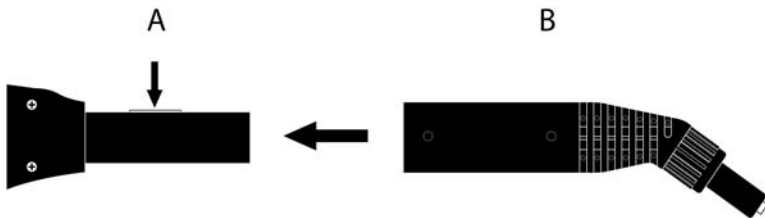

FIGURE 2

## ATTACHING UTILITY BRUSHES

**WARNING:** Do not try to connect accessories while unit is emitting steam.

**This section applies to all Utility Brushes. Note that Utility Brushes attach to Steam Jet Nozzle, not to main steam nozzle.**

1. Align guide tab on inside of Utility Brush (FIGURE 3-A) with groove on bottom of Steam Jet Nozzle tip (FIGURE 3-B), and firmly press Utility Brush onto Steam Jet Nozzle.
2. Press Utility Brush as far on to Steam Jet Nozzle as possible to ensure that it is properly sealed, to help prevent any steam leakage (FIGURE 4).
3. To remove Utility Brush, simply grip it firmly and pull it off of Steam Jet Nozzle.

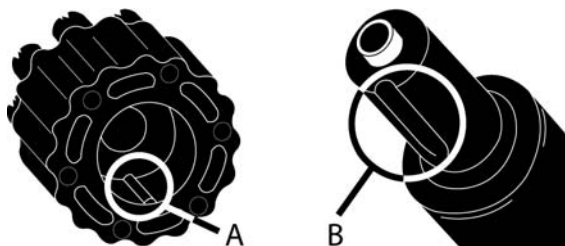

**FIGURE 3**

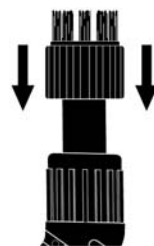
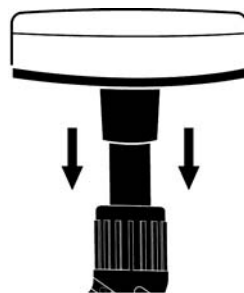

**FIGURE 4**

## ATTACHING SCRUB PAD

**This section applies to the Scrub Pad. Note that Scrub Pad attaches to Steam Jet Nozzle, not to main steam nozzle.**

1. Place Scrub Pad over tip of Steam Jet Nozzle, and firmly press it as far on to Steam Jet Nozzle as possible to ensure that it is properly sealed (FIGURE 5). This will help prevent any steam leakage.
2. To remove Scrub Pad, simply grip it firmly and pull it off of Steam Jet Nozzle.



**FIGURE 5**

# USING THE STEAM CLEANER

**SteamFast**

## FILLING WATER RESERVOIR WITH WATER

1. Place Steam Cleaner on a flat, level surface.
2. Make sure Lighted On/Off Switch is set to “Off” position and grounded power cord is unplugged from electrical outlet.
3. Flip up Storage Compartment lid. Cautiously unscrew and remove Water Reservoir cap.
4. Water Reservoir should always be emptied after each use. If it was not emptied after the last use, empty it now. This will prevent over-filling.
5. Fill Measuring Cup to maximum fill line (16 oz. / 473 ml.) with water.

**NOTE: To prolong the life of your Steam Cleaner, we recommend using distilled or de-mineralized water.**

6. Carefully pour water from Measuring Cup into Water Reservoir through fill hole.

**WARNING: Extreme caution should be used when pouring water into the Water Reservoir. Do not look directly down into fill hole when filling. Keep your free hand and any children or pets at a safe distance.**

7. Depending on how long you intend to steam, you may repeat steps 5 & 6 up to two more times, to have up to a maximum of 48 oz. (1,420 ml.) of water. See chart for a comparison of the amount of water vs. approximate steam time.

Amount of Water	Duration of Steam
16 oz. (473 ml.)	Approximately 15 min.
32 oz. (946 ml.)	Approximately 30 min.
48 oz. (1420 ml.)	Approximately 45 min.

8. Replace Water Reservoir cap, ensuring that it is screwed on tightly to prevent hot steam from escaping and causing injury.
9. Lower Storage Compartment lid back down.

## REFILLING WATER RESERVOIR AFTER USE

**If unit has been in use, always follow the safety precautions below before removing the Water Reservoir cap:**

1. Allow unit to cool for 5-10 minutes.
2. Press and hold Steam Button to release all remaining steam.

**WARNING: Failure to follow these precautions may result in burns from escaping steam when the Water Reservoir cap is removed.**

## OPERATING STEAM CLEANER

**NOTE:** Be sure that Water Reservoir has already been filled and that all desired accessories are connected before following these steps.

1. Plug grounded power cord into a convenient electrical outlet.

**CAUTION:** This unit uses a grounded (3-prong) electrical plug. Use only in properly installed 3-prong electrical outlets. Do not attempt to alter plug or circumvent this safety feature in any way.

2. Switch Lighted On/Off Switch to “On” position. Steam Ready Light will immediately illuminate.

**NOTE:** Steam Ready Light is illuminated while boiler is heating.

3. Steam Ready Light will deactivate in 2-8 minutes (depending on how much water is in Water Reservoir), indicating that boiler is heated and unit is ready to begin steaming.
4. Direct Steam Jet Nozzle (or other accessories) towards surface you desire to steam, and press Steam Button. To sanitize surfaces, point Steam Jet Nozzle, press Steam Button and hold approximately 1/2 inch from surface for at least 5 seconds. This will insure that you have killed germs and bacteria.

**CAUTION:** Always be sure that Steam Jet Nozzle and other accessories are pointed in a safe direction (away from yourself, other people, pets, and plants) before pressing Steam Button.

5. Keep Steam Button depressed for a continuous flow of steam. You may also slide the Steam Lock Switch forward while depressing the Steam Button to lock the Steam Button down. This will let you have a continuous flow of steam without having to hold down the Steam Button.
6. Using a slight back-and-forth motion over the area you are steaming will further enhance the cleaning process. Wipe steamed areas with a clean cloth to remove loosened dirt and grime. Wiping the area while it is still wet is recommended, but use caution when wiping surfaces such as metal that may still be hot.

**NOTE:** During use, the Steam Ready Light may illuminate. This is normal. If you notice a drop in steam pressure, release Steam Button until Steam Ready Light deactivates once again.

7. Once steaming tasks are complete, immediately set Lighted On/Off Switch to “Off” position and unplug grounded power cord from electrical outlet. Follow steps under **Proper Storage** procedure on page 11 of this manual.

### PROPER STORAGE

Preparing your Steam Cleaner for storage is quick and simple. When you have finished your steaming tasks, follow the steps listed below.

1. Switch Lighted On/Off Switch to “Off” position and unplug grounded power cord from electrical outlet.
2. Allow unit to completely cool (at least 30 minutes).
3. Press and hold Steam Button to release all remaining steam.
4. Remove all accessories from unit.
5. Drain any remaining water in Water Reservoir into a sink or tub to prevent over-filling during your next use.
6. Store accessories safely away, near Steam Cleaner. Utility Brushes can be conveniently stored in the Storage Compartment.
7. Store Steam Cleaner in a cool, dry location.

### REMOVING MINERAL BUILD-UP

A common problem with steam appliances is mineral build-up caused by high mineral content in many municipal water supplies. **The best way to avoid this is to use de-mineralized or distilled water in unit.** If you are unable to use de-mineralized or distilled water, we recommend you use this procedure monthly to help avoid mineral build-up:

1. Switch Lighted On/Off Switch to “Off” position and unplug grounded power cord from electrical outlet.
2. Allow unit to completely cool (at least 30 minutes).
3. Press and hold Steam Button to release all remaining steam.
4. Remove all accessories from unit.
5. Flip up Storage Compartment lid and remove Water Reservoir cap.
6. Drain water from Water Reservoir into sink or tub.
7. Using Measuring Cup, make a mixture of 8 oz. (237 ml.) vinegar and 8 oz. (237 ml.) water.
8. Slowly pour water-vinegar solution into Water Reservoir.
9. Allow to stand for 40 minutes.
10. Drain water-vinegar solution from Water Reservoir.
11. Rinse Water Reservoir with fresh water, drain and repeat until vinegar odor dissipates.
12. Replace Water Reservoir cap and lower Storage Compartment lid back down.

PROBLEM	POSSIBLE CAUSE	SOLUTION
Unit fails to steam. Lighted On/Off Switch <b>does not</b> illuminate.	Unit is not plugged in.	Plug into electrical outlet.
	Household Circuit Breaker / Ground Fault Interrupter has tripped or blown a fuse.	Reset Circuit Breaker / Ground Fault Interrupter, or replace fuse. If you need assistance, contact a licensed electrician.
Unit fails to steam. Lighted On/Off Switch <b>does</b> illuminate.	Water Reservoir is empty.	Refill Water Reservoir using procedures on page 9 of this manual.
	Mineral build-up in unit.	Follow <b>Removing Mineral Build-Up</b> procedure on page 11 of this manual.
Steam output is intermittent.	Mineral build-up in unit.	It is normal for unit to periodically stop steaming for a few seconds. If steam stays off for longer periods, follow <b>Removing Mineral Build-Up</b> procedure on page 11 of this manual.
Unit is emitting excess water.	Water condensation in Steam Hose.	Point main steam nozzle towards sink, tub or ground and shake while depressing Steam Button. Continue until excess water is released.
	Water Reservoir has been over-filled.	Point main steam nozzle towards sink, tub or ground and shake while depressing Steam Button to remove water that may have condensed in Steam Hose.  Empty some water out of Water Reservoir.
	Unit has not reached operating temperature.	Wait until Steam Ready Light deactivates to steam.

PROBLEM	POSSIBLE CAUSE	SOLUTION
Water spills out from Water Reservoir fill hole when adding water.	Water Reservoir is already full.	Do not try to add any more water.
	Water Reservoir is too hot to be refilled.	Allow more cooling time before refilling.  Fill Water Reservoir more slowly. Be sure to utilize the provided Measuring Cup and Water Funnel to refill the unit.
Accessories do not stay firmly attached to main steam nozzle.	Accessories are not being properly installed.	Review steps for proper installation of accessories on pages 7 & 8 of this manual. Check to ensure that accessories are installed correctly.
	Accessories or main steam nozzle is damaged or otherwise incorrect.	Contact our Customer Service Department for assistance.

## CUSTOMER SUPPORT

For problems with your Steam Cleaner, please refer to the troubleshooting guide located on Pages 12 & 13. Additional inquiries should be directed to our Customer Support services through our Web site, [www.SteamFast.com](http://www.SteamFast.com), on the *Contact Us* Web page.

If you do not have internet access, you may also contact our Customer Support Department by telephone, at **1-800-711-6617** or **1-816-584-9700**, ext. **130** or **131**.

**NOTE: In order for our customer service representatives to help you as quickly and efficiently as possible, please have the following information ready before calling:**

- Purchase information (where and when you purchased this product)
- Copy of purchase receipt / proof of purchase
- Product Serial Number

---

## PRODUCT SERIAL NUMBER

For your convenience, space has been provided below for you to record the serial number of your unit (located on the back or bottom of the unit) for easy reference when contacting our Customer Service Department.

\_\_\_\_\_ - \_\_\_\_\_



## WARRANTY INFORMATION

**SteamFast**

**Before returning any product for any reason, you MUST call or e-mail Top Innovations Warranty Service at (800) 711-6617 or [customerservice@topinnovations.com](mailto:customerservice@topinnovations.com) to obtain a Return Authorization Number.**

### 30-DAY MONEY BACK POLICY

If any item purchased directly from Top Innovations, Inc. does not meet your expectations, it may be returned within 30 days of the date of purchase for either a replacement or full refund of the purchase price less any shipping charges. In some circumstances, an additional restocking fee will apply.

### ONE YEAR LIMITED WARRANTY

(If outside USA, additional shipping charges may apply)

Top Innovations, Inc., warrants this product to be free from defects in material and workmanship for a period of (1) one year from the date of purchase. This warranty does not cover damage caused by misuse, negligence, use by improper current or voltage, commercial use, use contrary to operating instructions or disassembly, repair or alteration by any person other than Top Innovations, Inc. Warranty Service Department.

Top Innovations, Inc., will repair or replace at its option. This warranty gives you specific legal rights and may have other rights, which may vary from state to state.

Should there be any missing or defective parts or accessories, please contact Customer Support. In most cases, it is not necessary to return the entire unit. We can ship most replacement parts directly to your home.

Upon expiration of your One Year Limited Warranty, you will be advised of the cost of repair before any servicing is done. **You must have a Return Authorization Number before returning your product for any reason.** For non-warranty service, please enclose a check for the amount required. Or, you may pay by money order, Visa, MasterCard, AmEx or Discover credit card.

If you need to request warranty service, or have any questions about coverage under this warranty, please visit the Warranty Service Request page on our Web site, [www.SteamFast.com](http://www.SteamFast.com). You may also email [customerservice@topinnovations.com](mailto:customerservice@topinnovations.com), or phone (800) 711-6617 or (816) 584-9700, ext 130 or 131.

Please have your product serial number ready before contacting Warranty Service Department. The serial number is located on the back or bottom of your unit.

Performance of any obligation of this Warranty, or 30-Day Money Back Policy, may be obtained by:

1. Call (800) 711-6617 for a Return Authorization Number before returning your unit. Failure to obtain a Return Authorization Number will cause a delay in service.
2. Include a copy of purchase receipt.
3. Box the item securely, in its original packaging if available. Include original packing materials and accessories unless advised otherwise by a Customer Service agent.
4. Include your name, address, telephone number, and Return Authorization Number on returned package.

Send unit postage/freight-prepaid (Top Innovations does not accept "collect" or COD returns) to:

**Top Innovations, Inc.  
Warranty Service Department  
6655 Troost Ave.  
Kansas City, MO 64131**

Call Top Innovations, Inc., Customer Service at (800) 711-6617, or (816) 584-9700 if you have any questions about the procedures described above.

# ***SteamFast***<sup>®</sup>

## **Top Innovations, Inc.**

6655 Troost Ave.

Kansas City, MO 64131

Tel: (800) 711-6617

(816) 584-9700

***www.TopInnovations.com***

customerservice@topinnovations.com



Printed in China