

GARDENERS

SUPPLY COMPANY

PRODUCT BULLETIN

4 Wheel Scoot with Tray

This Garden Scoot comes with a contoured tractor-style seat that swivels a full 360 degrees. It allows you to harvest beans, paint the fence or wax the car from a comfortable sitting position, with free movement in all directions. The frame is made from 1-inch thick tubular steel and can support up to 400 pounds. Use the handy built-in accessory tray to carry tools, gloves and seeds wherever you go.

Assembly Instructions

Step 1. Lay out all parts and place the Main Frame (A) upright on a hard level surface (see diagram at right for all steps).

Step 2. Position an Axle Spacer (G) between the two front legs of the Main Frame (A). While holding the Spacer, Slide an Axle (H) through the predrilled hole in one front leg, through the Axle Spacer, then through the second front leg.

Step 3. Place a large washer on each end of the Axle. Place a Wheel (F) on each end of the Axle, with the valve stem facing out. Follow each Wheel with a washer. Affix both Wheels using the cotter pins provided. Slip the straight ends of the cotter pin through the small hole in the end of the Axle. Use pliers to spread the the ends of the cotter pin apart and wrap them around the Axle in the form of a wide "Y". Repeat Steps 2 and 3 to assemble the back Axle and Wheels.

Step 4. Position the Plastic Storage Tray (D) underneath the Main Frame (A). Take a Bracket (E) and line it up with the predrilled holes in the rim of the Storage Tray (D). *The Bracket is curved to partially wrap around the tubular frame.* Insert 2 bolts with washers through the Bracket from the outside and into the rim of the Storage Tray.

Place a Brace on the bolts from underneath and secure with nuts. Tighten both the front and back Brackets and Braces using an adjustable wrench and a screwdriver.

Over, please

Parts:	Description	Qty.
	A Main Frame	1
	B Seat	1
	C Elevating Bolt	1
	D Plastic Storage Tray	1
	E Bracket and Brace	2 sets
	F Wheels	4
	G Axle Spacers	2
	H Axle	2
	Flathead Bolts	4
	Phillips Head Bolts	4
	Washers	16
	Locking nut	8
	Cotter Pins	4

Tools Needed:	
	• Pliers
	• Phillips screwdriver
	• Flathead screwdriver
	• Adjustable wrench

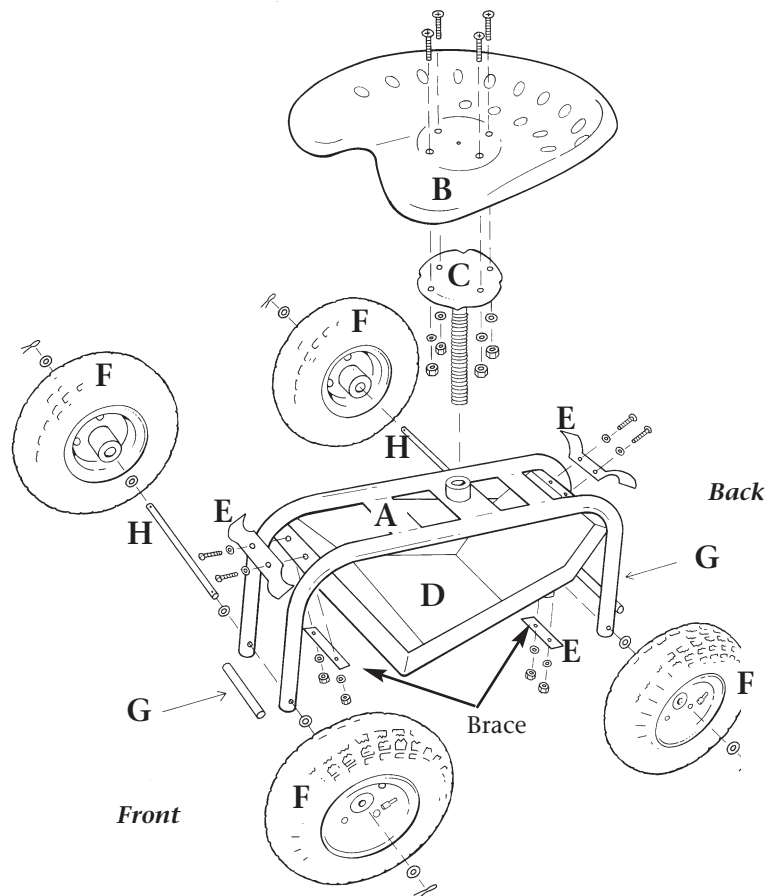

Be sure the Plastic Bin is positioned properly so that it does not obstruct movement of the wheels.

Step 5. Connect the Elevating Bolt (C) to the Seat (B) using the four large Phillips head bolts and large washers. Place a washer on each bolt from underneath and secure with nuts. Tighten the bolts using a combination of an adjustable wrench and screwdriver.

Step 6. Attach the Seat (B) by screwing it into the threaded hole on top of the frame. Push down on the top of the Seat as you screw so that the threads catch. You can adjust the height of the seat by turning clockwise or counterclockwise.

Safety Information

- Make sure the seat is screwed into the Main Frame and in a secure position before sitting on or using the 4 Wheel Garden Scoot.
- Do not allow children to play on or with the 4 Wheel Garden Scoot and keep it out of reach of children when not in use.
- Keep the tires inflated to the rated pressure indicated on the tires to prevent damage to the tread or tube.

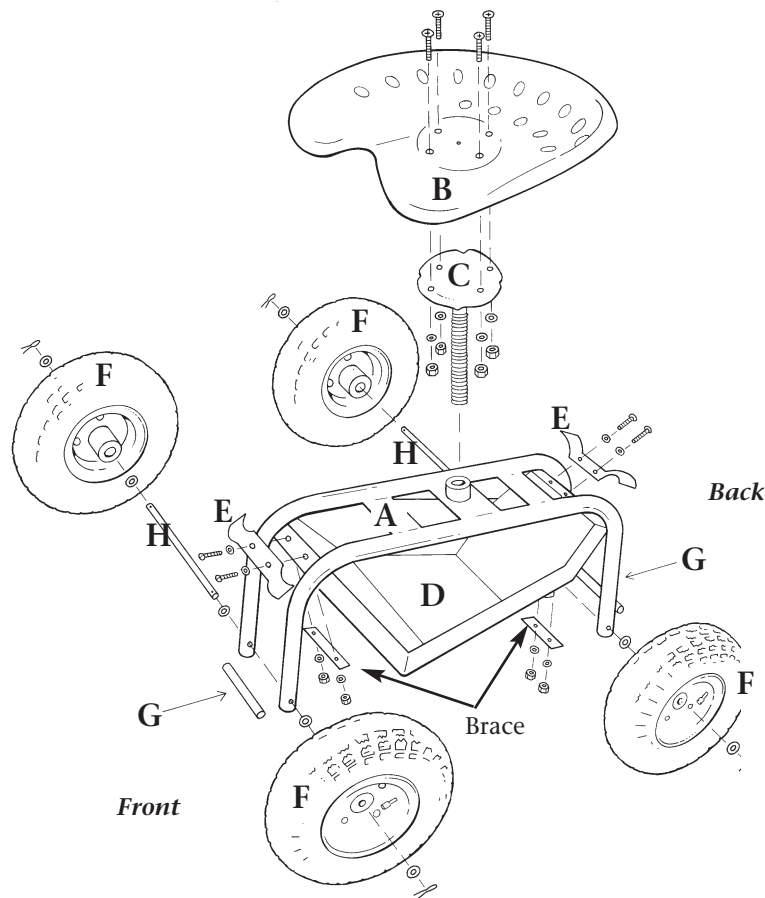

Ordering Information

#33-938 4 Wheel Scoot with Tray

To place an order, please call us or see our web site for current prices.

128 Intervale Road, Burlington, Vermont 05401
PHONE ORDERS: 1-800-427-3363 CUSTOMER SERVICE: 1-800-876-5520
E-MAIL: info@gardeners.com WEB: www.gardeners.com